

INSTALL GUIDE



CORRECT INSTALLATION METHOD FOR ROOFS AND WALLS

Like all other building products, insulation performs best when it is installed correctly. It is possible to install any of the Reflecta-Shed Range™ products over roof battens, however the ABCB condensation handbook clearly recommends that condensation management is best provided when the roof and insulation are separated. Installation requires an attention to detail to ensure compliance with Building Code requirements and to effectively manage condensation.

ROOFS

- 1 Roll out the suitable Reflecta-Shed Range™ product across the top of the purlin.
- 2 Allow a sag to achieve a nominal air space of 40mm between the product and roof sheeting.
- 3 Roll out the next roll of Reflecta-Shed Range™ overlapping by no less than 150mm, or use 72mm wide reinforced aluminium joining tape (PPC#493 72mm) if overlap is not less than 50mm but less than 150mm. Alternatively, a 24-48mm wide double sided cloth tape (PPC#333 48mm) can be used to provide a concealed adhesion between the overlap.
- 4 Roof sheeting can then be installed by screwing through the Reflecta-Shed Range™ to the steel purlins or timber roof structure.

WALLS

- 1 Roll out the suitable Reflecta-Shed Plus™ insulation product horizontally on the outside of studs or framing.
- 2 Install the product from the bottom of stud or framing.
- 3 Roll out the next roll of Reflecta-Shed Range™.

- 4 Where overlap is not less than 50mm but less than 150mm, use a 72mm wide reinforced aluminium joining tape (PPC#493 72mm).
- 5 Allow a nominal air space of 25mm either side of the insulation to achieve required R-values. This is easily achievable by pushing insulation inwards between the studs.

NOTE: This product is not suitable whenever a non-combustible product is required.

VAPOUR CONTROL MEMBRANCE

If the product is installed and used as a vapour control membrane, Class 1 or Class 2, or as an air barrier, it shall be continuously sealed at all discontinuities, end laps, joints and penetrations by

- A pressure sensitive, heat and moisture resistant tape;
- Adhesive of equal or greater vapour resistance than the vapour control membrane;
- Heat and moisture resistant adhesive tape;
- Mechanical fixing with adhesive sealant; or
- Adhesive bond.

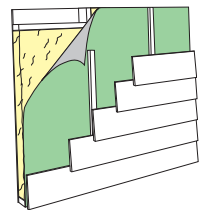
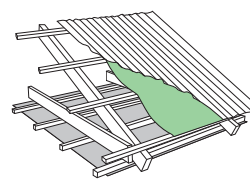

Products are to be stored standing upright and on pallets not more than two high. Product warranty is voided for any product stored horizontally resulting in squeeze or crush. Returns of product displaying effects of deformation due to incorrect storage practices will not be accepted.

The product information included in this publication is provided in good faith in order to ensure the optimum performance of this product. However, no warranty is given or implied with respect to this information or the product itself regarding the product's suitability for any particular purpose, as factors outside our knowledge and control may affect its use. The usage of this and other building membranes will affect moisture migration in the building element. The purchaser is responsible for independently determining the sustainability of the product for the intended purpose. GI Building Services Pty Ltd reserves the right to amend product specifications without prior notice. Information provided is considered to be true and correct at the time of publication.

Issued July 2022