

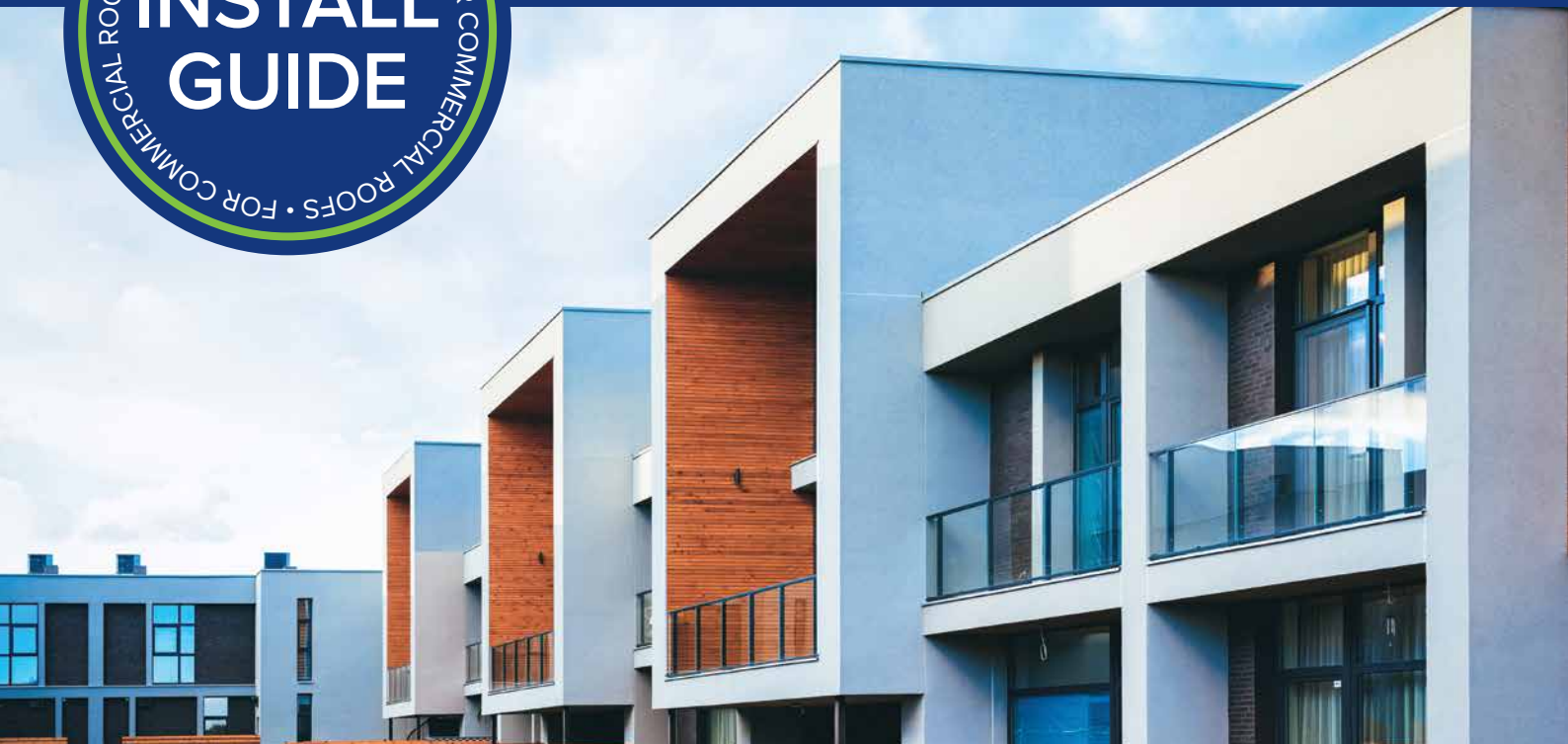

# Reflecta-Cell Plus™

## THERMAL & SOUND INSULATION



### CORRECT INSTALLATION METHOD FOR COMMERCIAL ROOFS

#### Correct Installation of Insulation

Like all other building products, insulation performs best when it is installed correctly. Whether a bulk insulation that requires spacers or a reflective insulation that is installed directly under roof, installation requires an attention to detail to ensure compliance with Building Code requirements and to effectively manage condensation.

Once you have chosen the suitable **GI Building Sciences™ Reflecta-Range™** product (Reflecta-Guard Plus™, Reflecta-Cell Plus™, Reflecta-Shield Plus™) for your project, simply follow the instructions below.

- STEP 1** Having provided appropriate fall arrest to your building (*where required under the NCC*), roll out the **Reflecta-Range™** product across the top of steel purlins or timber roof structure.
- STEP 2** Allow a sag to achieve a nominal air space of 40mm between the product and roof sheeting.
- STEP 3** Roll out the next roll of insulation overlapping by no less than 150mm.
- STEP 4** Where overlapping is less than 150mm, but not less than 50mm, use 72 mm wide (or greater) reinforced aluminium tape to join. Alternatively, a 24-48mm wide double sided cloth tape can be used to provide adhesion between the overlap.
- STEP 5** Roof sheeting can be installed by screwing through the GI Building Sciences™ product to the steel purlins or timber roof structure.

### VAPOUR CONTROL MEMBRANE

If the product is installed and used as a vapour control membrane, Class 1 or Class 2, or as an air barrier, it shall be continuously sealed at all discontinuities, end laps, joints and penetrations by

- A pressure sensitive, heat and moisture resistant tape;
- Adhesive of equal or greater vapour resistance than the vapour control membrane;
- Heat and moisture resistant adhesive tape;
- Mechanical fixing with adhesive sealant; or
- Adhesive bond.

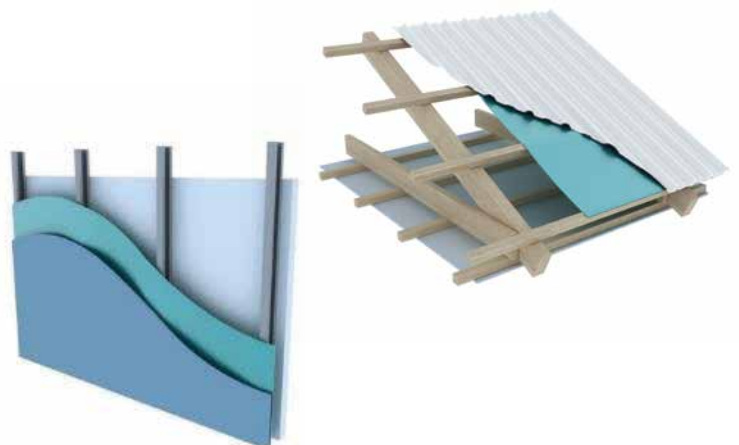

Products are to be stored standing upright and on pallets not more than two high. Product warranty is voided for any product stored horizontally resulting in squeeze or crush. Returns of product displaying effects of deformation due to incorrect storage practices will not be accepted.

The product information included in this publication is provided in good faith in order to ensure the optimum performance of this product. However, no warranty is given or implied with respect to this information or the product itself regarding the product's suitability for any particular purpose, as factors outside our knowledge and control may affect its use. The usage of this and other building membranes will affect moisture migration in the building element. The purchaser is responsible for independently determining the sustainability of the product for the intended purpose. GI Building Services Pty Ltd reserves the right to amend product specifications without prior notice. Information provided is considered to be true and correct at the time of publication.

Issued July 2022